

**SCREWED PIPE FLANGES**

 Nominal Pressure: 10 and 16kgf/cm<sup>2</sup>-ND10-ND16

DIN2566

**FLANGES**

BORULARICIN,VIDALI

 Anma Basinc1:10ve 16kgf/cm<sup>2</sup>-ND10-ND16

TS813 (TS ISO 7005-1)

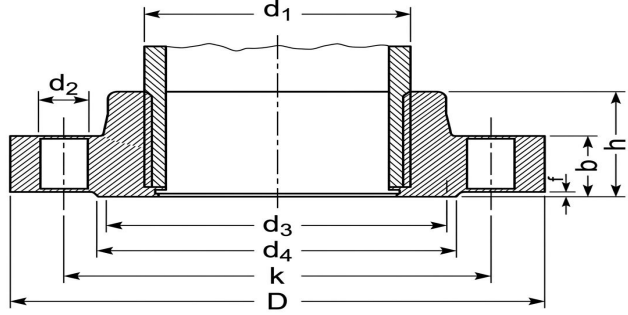

BORU(Pipe)		FLANS(Flange)					BOYUN (Neck)	ALINCIKINTISI (Raised face)			CIVATALAR(Bolts)			FLANSGRILIGI (Flange weight) (7.85kg/dm <sup>3</sup> )kg
DN	d1	Bor Vidasi (Whitwort)	D	b	k	h	d3	d4	f	Sayisi Each	Vida Screw	d2		
6	10.2	R1/8"	75	12	50	18	20	32	2	4	M10	11	0.326	
8	13.5	R1/4"	80	12	55	18	25	38	2	4	M10	11	0.38	
10	17.2	R3/8"	90	14	60	20	30	40	2	4	M12	14	0.544	
15	21.3	R1/2"	95	14	65	20	35	45	2	4	M12	14	0.613	
20	26.9	R3/4"	105	16	75	24	45	58	2	4	M12	14	0.91	
25	33.7	R1"	115	16	85	24	52	68	2	4	M12	14	1.1	
32	42.4	R1 1/4"	140	16	100	26	60	78	2	4	M16	18	1.6	
40	48.3	R1 1/2"	150	16	110	26	70	88	3	4	M16	18	1.78	
50	60.3	R2"	165	18	125	28	85	102	3	4	M16	18	2.43	
65	76.1	R2 1/2"	185	18	145	32	105	122	3	4	M16	18	3.18	
80	88.9	R3"	200	20	160	34	118	138	3	4/8	M16	18	4.12	
100	114.3	R4"	220	20	180	38	140	158	3	8	M16	18	4.47	
125	139.7	R5"	250	22	210	40	168	188	3	8	M16	18	6.13	
150	168.7	R6"	285	22	240	44	196	212	3	8	M20	22	7.92	

**DIN 6Bar**

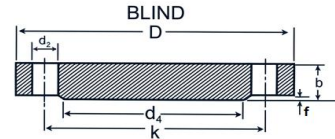
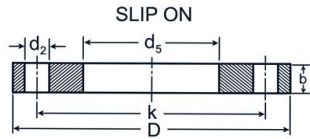
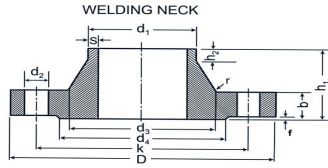
 DIN 2573 Slip On Flange  
 DIN 2527 Blind Flange  
 DIN 2631 Welding Neck Flange

BORE			COMMON DIMENSION			HUB					RAISED FACE		DRILLING		Approx. Weight(kg)				
DN	d <sub>1</sub>	d <sub>5</sub>	D	b			k	h <sub>1</sub>	d <sub>3</sub>	S	r	h <sub>2</sub>	d <sub>4</sub>	f	Number of Bolt	d <sub>2</sub>	DIN 2573	DIN 2631	DIN 2527
				Welding neck	Slip On	Blind													
15	20	21	80	12	12	12	55	30	28	2	4	6	40	2	4	11	0.41	0.392	
	21.3	22							30										
20	25	26	90	14	14	14	65	32	35	2.3	4	6	50	2	4	11	0.6	0.592	
	26.9	27.6							38										
25	30	31	100	14	14	14	75	35	40	2.6	4	6	60	2	4	11	0.74	0.747	
	33.7	34.4							42										
32	38	39	120	14	16	14	90	35	50	2.6	6	6	70	2	4	14	1.19	1.05	
	42.4	43.1							55										
40	44.5	45.5	130	14	16	14	100	38	58	2.6	6	7	80	3	4	14	1.39	1.18	
	48.3	49							62										
50	57	58.1	140	14	16	14	110	38	70	2.9	6	8	90	3	4	14	1.53	1.34	
	60.3	61.1							74										
65	76.1	77.1	160	14	16	14	130	38	88	2.9	6	9	110	3	4	14	1.89	1.67	2.48
80	88.9	90.3	190	16	18	16	150	42	102	3.2	8	10	128	3	4	18	2.98	2.71	3.49
	114.3	115.9							130										
100	108	109.6	210	16	18	16	170	45	122	3.6	8	10	148	3	4	18	3.46	3.24	4.86
	114.3	115.9							130										
125	133	134.8	240	18	20	18	200	48	148	4	8	10	178	3	8	18	4.6	4.49	6.28
	139.7	141.6							155										
150	159	161.1	265	18	20	18	225	48	172	4.5	10	12	202	3	8	18	5.22	5.15	7.75
	168.3	170.5							184										
200	219.1	221.8	320	20	22	20	280	55	236	5.9	10	15	258	3	8	18	7.15	7.78	12.7
250	267	270.2	375	22	24	22	335	60	282	6.3	12	15	312	3	12	18	9.61	10.8	19
	273	276.2							290										
300	323.9	327.6	440	22	24	22	395	62	342	7.1	12	15	365	4	12	22	12.6	14	26.3
350	355.6	359.7	490	22	26	22	445	62	385	7.1	12	15	415	4	12	22	15.6	16.7	32.9
	368	372.2							385										
400	406.4	411	540	22	28	22	495	65	438	7.1	12	15	465	4	16	22	18.4	19	40.2
	419	423.7							438										
500	508	513.6	645	24	30	24	600	68	538	7.1	12	15	570	4	20	22	24.6	28.6	63.2

**DIN 10Bar**

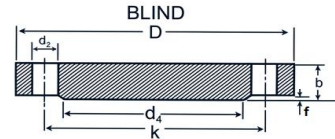
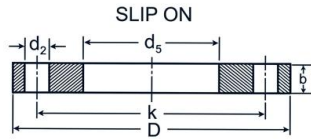
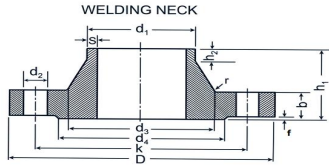
 DIN 2576 Slip On Flange  
 DIN 2527 Blind Flange  
 DIN 2632 Welding Neck Flange

BORE			COMMON DIMENSION			HUB					RAISED FACE		DRILLING		Approx. Weight(kg)				
DN	d1	d5	D	b			k	h1	d3	S	r	h2	d4	f	Number of Bolt	d2	DIN 2576	DIN 2632	DIN 2527
				Welding neck	Slip On	Blind													
10	14	14.5	90	14	14	14	60	35	25	1.8	4	6	40	2	4	14	0.613	0.58	0.63
	17.2	17.7							28								0.605		
15	20	21	95	14	14	14	65	35	30	2	4	6	45	2	4	14	0.675	0.648	0.72
	21.3	22							32								0.669		
20	25	26	105	16	16	16	75	38	38	2.3	4	6	58	2	4	14	0.943	0.952	1.01
	26.9	27.6							40								0.936		
25	30	31	115	16	16	16	85	38	42	2.6	4	6	68	2	4	14	1.14	1.14	1.23
	33.7	34.4							45								1.11		
32	38	39	140	16	16	16	100	40	52	2.6	6	6	78	2	4	18	1.66	1.69	1.8
	42.4	43.1							56								1.62		
40	44.5	45.5	150	16	16	16	110	42	60	2.6	6	7	88	3	4	18	1.89	1.86	2.09
	48.3	49							64								1.86		
50	57	58.1	165	18	18	18	125	45	72	2.9	6	8	102	3	4	18	2.51	2.53	2.88
	60.3	61.1							75								2.47		
65	76.1	77.1	185	18	18	18	145	45	90	2.9	6	10	122	3	4	18	3	3.06	3.66
80	88.9	90.3	200	20	20	20	160	50	105	3.2	8	10	138	3	8	18	3.79	3.7	4.77
100	108	109.6	220	20	20	20	180	52	125	3.6	8	12	158	3	8	18	4.2	4.62	5.65
	114.3	115.9							131								4.03		
125	133	134.8	250	22	22	22	210	55	150	4	8	12	188	3	8	18	5.71	6.3	8.42
	139.7	141.6							156								5.46		
150	159	161.1	285	22	22	22	240	55	175	4.5	10	12	212	3	8	22	6.72	7.75	10.4
	168.3	170.5							184								6.57		
175	193.7	196.1	315	24	24	24	270	60	210	5.4	10	12	242	3	8	22	8.45	9.85	14
200	219.1	221.8	340	24	24	24	295	62	235	5.9	10	16	268	3	8	22	9.31	11.3	16.9
250	267	270.2	395	26	26	26	350	68	285	6.3	12	16	320	3	12	22	12.5	14.7	24.7
	273	276.2							292								11.9		

### DIN 10Bar

DIN 2576 Slip On Flange  
 DIN 2527 Blind Flange  
 DIN 2632 Welding Neck Flange

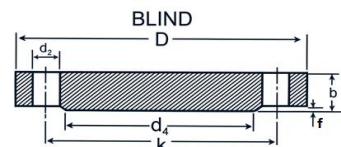
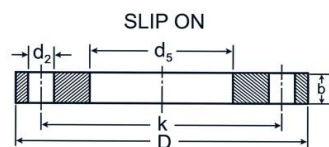
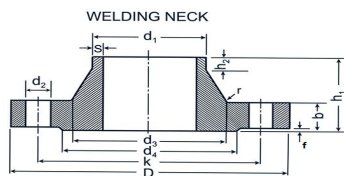

BORE			COMMON DIMENSION				HUB					RAISED FACE		DRILLING		Approx. Weight(kg)			
DN	d <sub>1</sub>	d <sub>5</sub>	D	b			k	h <sub>1</sub>	d <sub>3</sub>	S	r	h <sub>2</sub>	d <sub>4</sub>	f	Number of Bolt	d <sub>2</sub>	DIN 2576	DIN 2632	DIN 2527
				Welding neck	Slip On	Blind													
300	323.9	327.6	445	26	26	26	400	68	344	7.1	12	16	370	4	12	22	13.8	17.4	31.9
350	355.6	359.7	505	26	28	26	460	68	385	7.1	12	16	430	4	16	22	20.6	21.6	41.9
	368	372.2															19		
400	406.4	411	565	26	32	26	515	72	440	7.1	12	16	482	4	16	26	27.9	26.2	51.2
	419	423.7															25.9		
500	508	513.6	670	28	38	28	620	75	542	7.1	12	16	585	4	20	26	41.1	38.1	77.8
600	610	616.5	780	28	40		725	80	642	7.1	12	18	685	5	20	30	51.87	44.6	
700	711	716	895	30	40		840	80	745	8	12	18	800	5	24	30	65.79	62.4	
800	813	818	1015	32	44		950	90	850	8	12	18	905	5	24	33	90.87	84.1	
900	914	920	1115	34	48		1050	95	950	10	12	20	1005	5	28	33	108.41	98.5	
1000	1016	1022	1230	34	50		1160	95	1052	10	16	20	1110	5	28	36	133.21	115	
1200	1220	1226	1455	38	54		1380	115	1255	11	16	25	1330	5	32	39	188.2	182	
1400	1420	1426	1675	42	60		1590	120	1460	12	16	25	1535	5	36	42	262.14	248	
1600	1620	1626	1915	46	64		1820	130	1665	14	16	25	1760	5	40	48	367.43	347	
1800	1820	1826	2115	50	70		2020	140	1868	15	16	30	1960	5	44	48	447.79	430	
2000	2020	2026	2325	54	76		2230	150	2072	16	16	30	2170	5	48	48	577.77	539	
2200	2220	2226	2550	58	82		2440	160	2275	18	18	35	2370	6	52	56	699.88	658	
2400	2420	2426	2760	62	88		2650	170	2478	20	18	35	2570	6	56	56	844.49	825	
2600	2620	2626	2960	66	94		2850	180	2680	22	18	40	2780	6	60	56	972.23	979	
2800	2820	2826	3180	70	100		3070	190	2882	22	18	40	3000	6	64	56	1187.1	1156	
3000	3020	3026	3405	75	106		3290	200	3085	24	18	45	3210	6	68	62	1422.06	1420	

**DIN 16Bar**  
 DIN 2502 Slip On Flange  
 DIN 2527 Blind Flange  
 DIN 2633 Welding Neck Flange

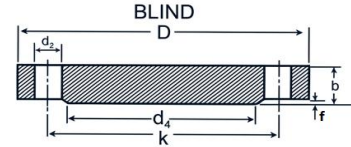
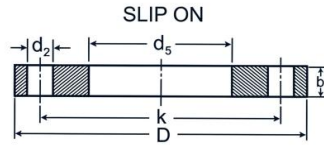
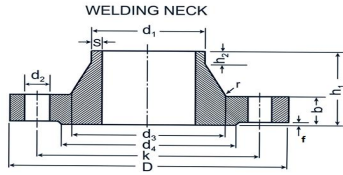

BORE			COMMON DIMENSION				HUB					RAISED FACE		DRILLING		Approx. Weight(kg)			
DN	d <sub>1</sub>	d <sub>5</sub>	D	b			k	h <sub>1</sub>	d <sub>3</sub>	S	r	h <sub>2</sub>	d <sub>4</sub>	f	Number of Bolt	d <sub>2</sub>	DIN 2502	DIN 2633	DIN 2527
				Welding neck	Slip On	Blind													
10	14	14.5	90	14	14	14	60	35	25	1.8	4	6	40	2	4	14	0.613	0.58	0.63
	17.2	17.7							28								0.605		
15	20	21	95	14	14	14	65	35	30	2	4	6	45	2	4	14	0.675	0.648	0.72
	21.3	22							32								0.669		
20	25	26	105	16	16	16	75	38	38	2.3	4	6	58	2	4	14	0.943	0.952	1.01
	26.9	27.6							40								0.936		
25	30	31	115	16	16	16	85	38	42	2.6	4	6	68	2	4	14	1.14	1.14	1.23
	33.7	34.4							45								1.11		
32	38	39	140	16	16	16	100	40	52	2.6	6	6	78	2	4	18	1.66	1.69	1.8
	42.4	43.1							56								1.62		
40	44.5	45.5	150	16	16	16	110	42	60	2.6	6	7	88	3	4	18	1.89	1.86	2.09
	48.3	49							64								1.86		
50	57	58.1	165	18	18	18	125	45	72	2.9	6	8	102	3	4	18	2.51	2.53	2.88
	60.3	61.1							75								2.47		
65	76.1	77.1	185	18	18	18	145	45	90	2.9	6	10	122	3	4	18	3	3.06	3.66
80	88.9	90.3	200	20	20	20	160	50	105	3.2	8	10	138	3	8	18	3.79	3.7	4.77
100	108	109.6	220	20	20	20	180	52	125	3.6	8	12	158	3	8	18	4.2	4.62	5.65
	114.3	115.9							131								4.03		
125	133	134.8	250	22	22	22	210	55	150	4	8	12	188	3	8	18	5.71	6.3	8.42
	139.7	141.6							156								5.46		
150	159	161.1	285	22	22	22	240	55	175	4.5	10	12	212	3	8	22	6.72	7.75	10.4
	168.3	170.5							184								6.57		
175	193.7	196.1	315	24	24	24	270	60	210	5.4	10	12	242	3	8	22	8.45	9.85	14
200	219.1	221.8	340	24	24	24	295	62	235	5.9	10	16	268	3	12	22	9.31	11	16.1
250	267	270.2	405	26	26	26	355	70	285	6.3	12	16	320	3	12	26	13.4	15.6	24.9
	273	276.2							292								17.4		
300	323.9	327.6	460	28	28	28	410	78	344	7.1	12	16	378	4	12	26	17.4	22	35.1

DIN 16Bar

DIN 2502 Slip On Flange  
 DIN 2527 Blind Flange  
 DIN 2633 Welding Neck Flange

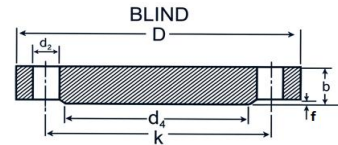
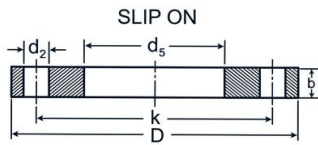
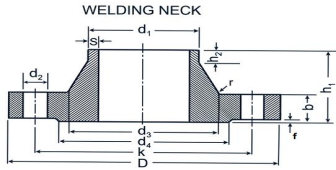

BORE			COMMON DIMENSION				HUB						RAISED FACE		DRILLING		Approx. Weight(kg)		
DN	d <sub>1</sub>	d <sub>5</sub>	D	b			k	h <sub>1</sub>	d <sub>3</sub>	S	r	h <sub>2</sub>	d <sub>4</sub>	f	Number of Bolt	d <sub>2</sub>	DIN 2502	DIN 2633	DIN 2527
				Welding neck	Slip On	Blind													
350	355.6	359.7	520	30	30	30	470	82	390	8	12	16	438	4	16	26	26.6	28.8	47.8
	368	372.2																	
400	406.4	411	580	32	32	32	525	85	445	8	12	16	490	4	16	30	30.9	36.3	63.5
	419	423.7																	
500	508	513.6	715	34	38	34	650	90	548	8	12	16	610	4	20	33	54	61	102
600	610	616.5	840	36	42	36	770	95	652	8.8	12	18	725	5	20	36	77.58	75.4	149.7
700	711	716	910	36	44	36	840	100	755	8.8	12	18	795	5	24	36	77.13	77	173.7
800	813	818	1025	38	50	38	950	105	855	10	12	20	900	5	24	39	106.35	101	235.5
900	914	920	1125	40	54	40	1050	110	955	10	12	20	1000	5	28	39	125.39	122	298.8
1000	1016	1022	1255	42	60	42	1170	120	1058	10	16	22	1115	5	28	42	177.99	162	390.7
1200	1220	1226	1485	48	68	48	1390	130	1262	12.5	16	30	1330	5	32	48	263.46	243	624.8
1400	1420	1426	1685	52	74	52	1590	145	1465	14.2	16	30	1530	5	36	48	329.77	323	872.6
1600	1620	1626	1930	58	82	58	1820	160	1668	16	16	35	1750	5	40	56	483.11	479	1275.1
1800	1820	1826	2130	62	88	62	2020	170	1870	17.5	16	35	1950	5	44	56	577.63	599	1661.9
2000	2020	2026	2345	66	94	66	2230	180	2072	20	16	40	2150	5	48	62	720.85	719	2142.1

DIN 25Bar  
 DIN 2503 Slip On Flange  
 DIN 2527 Blind Flange  
 DIN 2634 Welding Neck Flange

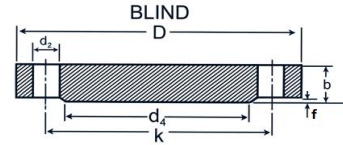
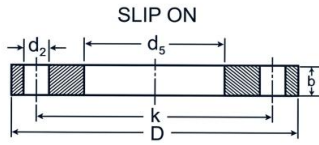
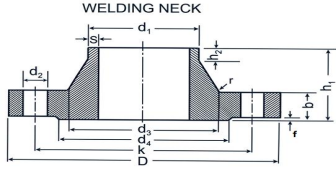

BORE			COMMON DIMENSION			HUB						RAISED FACE		DRILLING		Approx. Weight(kg)			
DN	d <sub>1</sub>	d <sub>5</sub>	D	b			k	h <sub>1</sub>	d <sub>3</sub>	S	r	h <sub>2</sub>	d <sub>4</sub>	f	Number of Bolt	d <sub>2</sub>	DIN 2503	DIN 2634	DIN 2527
				Welding neck	Slip On	Blind													
10	14	14.5	90	16	16	16	60	35	25	1.8	4	6	40	2	4	14	0.7	0.661	
	17.2	17.7							28										
15	20	21	95	16	16	16	65	38	30	2	4	6	45	2	4	14	0.771	0.746	
	21.3	22							32										
20	25	26	105	18	18	18	75	40	38	2.3	4	6	58	2	4	14	1	1.06	
	26.9	27.6							40										
25	30	31	115	18	18	18	85	40	42	2.6	4	6	68	2	4	14	1.28	1.29	
	33.7	34.4							46										
32	38	39	140	18	18	18	100	42	52	2.6	6	6	78	2	4	18	1.87	1.88	
	42.4	43.1							56										
40	44.5	45.5	150	18	18	18	110	45	60	2.6	6	7	88	3	4	18	2.13	2.33	
	48.3	49							64										
50	57	58.1	165	20	20	20	125	48	72	2.9	6	8	102	3	4	18	2.79	2.82	
	60.3	61.1							75										
65	76.1	77.1	185	22	22	22	145	52	90	2.9	6	10	122	3	8	18	3.48	3.74	4.33
80	88.9	90.3	200	24	24	24	160	58	105	3.2	8	12	138	3	8	18	4.35	4.75	5.94
100	108	109.6	235	24	24	24	190	65	128	3.6	8	12	162	3	8	22	5.78	6.52	7.64
	114.3	115.9							134										
125	133	134.8	270	26	26	26	220	68	155	4	8	12	188	3	8	26	7.87	9.07	11
	139.7	141.6							162										
150	159	161.1	300	28	28	28	250	75	182	4.5	10	12	218	3	8	26	10.1	11.8	14.7
	168.3	170.5							192										
175	191	193	330	28	28	28	280	75	215	5.6	10	15	248	3	12	26	11	13.4	17.6
	193.7	196							218										

DIN 25Bar  
 DIN 2503 Slip On Flange  
 DIN 2527 Blind Flange  
 DIN 2634 Welding Neck Flange

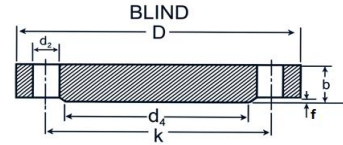
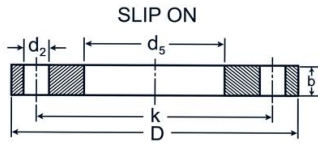
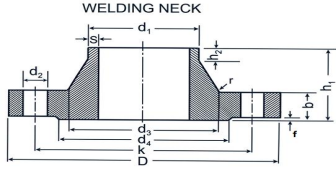

BORE			COMMON DIMENSION				HUB						RAISED FACE		DRILLING		Approx. Weight(kg)		
DN	d <sub>1</sub>	d <sub>5</sub>	D	b			k	h <sub>1</sub>	d <sub>3</sub>	S	r	h <sub>2</sub>	d <sub>4</sub>	f	Number of Bolt	d <sub>2</sub>	DIN 2503	DIN 2634	DIN 2527
				Welding neck	Slip On	Blind													
200	216	219	360	30	30	30	310	80	240	6.3	10	16	278	3	12	26	13.6	17	22.7
	219.1	221.8							244										
250	267	270	425	32	32	32	370	88	292	7.1	12	18	335	3	12	30	19.4	24.4	34.5
	273	276.2							298										
300	318	322	485	34	34	34	430	92	345	8	12	18	395	4	16	30	25	31.2	47.3
	323.9	327.6							352										
350	355.6	359.7	555	38	38	38	490	100	398	8	12	20	450	4	16	33	38.2	47.2	69.3
	368	372.2							44.2										
400	406.4	411	620	40	40	40	550	110	452	8.8	12	20	505	4	16	36	48.8	61.7	91.5
	419	423.7							57.9										
500	508	513.6	730	44	44	45	660	125	558	10	12	20	615	4	20	36	67.2	89.6	141
600	610	616.5	845	46	50		770	125	660	11	12	20	720	5	20	39	93.57	104	
700	711	716	960	46	52		875	125	760	12.5	12	20	820	5	24	42	117.53	136	
800	813	818	1085	50	56		990	135	865	14.2	12	22	930	5	24	48	156.31	186	
900	914	920	1185	54	62		1090	145	968	16	12	24	1030	5	28	48	188.57	236	
1000	1016	1022	1320	58	68		1210	155	1070	17.5	16	24	1140	5	28	56	255.97	307	

**DIN 40Bar**

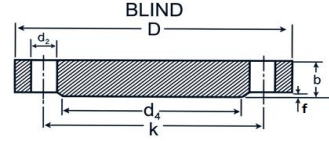
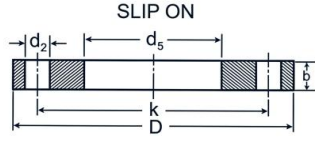
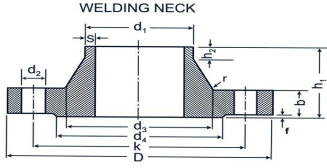
 DIN 2503 Slip On Flange  
 DIN 2527 Blind Flange  
 DIN 2635 Welding Neck Flange

BORE			COMMON DIMENSION			HUB						RAISED FACE		DRILLING		Approx. Weight(kg)			
DN	d1	d5	D	b			k	h1	d3	S	r	h2	d4	f	Number of Bolt	d2	DIN 2503	DIN 2635	DIN 2527
				Welding neck	Slip On	Blind													
15	20	21	95	16	16	16	65	38	30	2	4	6	45	2	4	14	0.771	0.746	
	21.3	22							32										
20	25	26	105	18	18	18	75	40	38	2.3	4	6	58	2	4	14	1	1.06	
	26.9	27.6							40										
25	30	31	115	18	18	18	85	40	42	2.6	4	6	68	2	4	14	1.28	1.29	
	33.7	34.4							46										
32	38	39	140	18	18	18	100	42	52	2.6	6	6	78	2	4	18	1.87	1.88	
	42.4	43.1							56										
40	44.5	45.5	150	18	18	18	110	45	60	2.6	6	7	88	3	4	18	2.13	2.33	
	48.3	49							64										
50	57	58.1	165	20	20	20	125	48	72	2.9	6	8	102	3	4	18	2.79	2.82	
	60.3	61.1							75										
65	76.1	77.1	185	22	22	22	145	52	90	2.9	6	10	122	3	8	18	3.48	3.74	4.33
80	88.9	90.3	200	24	24	24	160	58	105	3.2	8	12	138	3	8	18	4.35	4.75	5.94
	114.3	115.9							134										
100	108	109.6	235	24	24	24	190	65	128	3.6	8	12	162	3	8	22	5.78	6.52	7.64
	114.3	115.9							134										
125	133	134.8	270	26	26	26	220	68	155	4	8	12	188	3	8	26	7.87	9.07	11
	139.7	141.6							162										
150	159	161.1	300	28	28	28	250	75	182	4.5	10	12	218	3	8	26	10.1	11.8	14.7
	168.3	170.5							192										
200	219.1	221.8	375	34	34	34	320	88	244	6.3	10	16	285	3	12	30	17.4	21.5	27.6
250	267	270.2	450	38	38	38	385	105	298	7.1	12	18	345	3	12	33	27.6	34.9	44.5
	273	276.2							306										
300	323.9	327.6	515	42	42	42	450	115	362	8	12	18	410	4	16	33	37.8	49.7	64.3
350	355.6	359.7	580	46	46	46	510	125	408	8.8	12	20	465	4	16	36	53.4	68.1	90.8
	368	372.2							408										
400	406.4	411	660	50	50	50	585	135	462	11	12	20	535	4	16	39	75.4	96.5	129
	419	423.7							462										
500	508	513.6	755	52	52	56	670	140	562	14.2	12	20	615	4	20	42	88.3	117	175

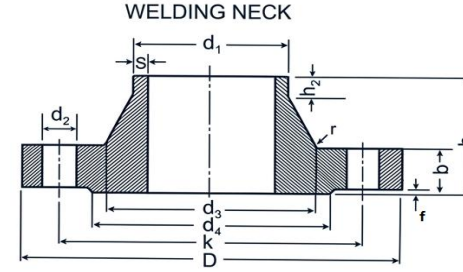
**Welding Neck Flange**
**Nominal Pressure: 64kgf/cm<sup>2</sup>-ND64**
**DIN2636**
**FLANSLAR**
**BORULARICIN,VIDALIBOYUNLARI KAYNAKLI**
**Anma Basinc1:64kgf/cm<sup>2</sup>-ND64**
**TS811/7 (TS ISO 7005-1)**

BORE(Pipe)		FLANS(Flange)				BOYUN(Neck)				ALIN ÇIKINTISI (Raised face)		CLVATALAE(Bolts)			FLANS AĞIRLIĞI (Flange Weight) (7.85kg/dm <sup>3</sup> )kg
DN	d <sub>1</sub> ISO/DIN	D	b	k	h <sub>1</sub>	d <sub>3</sub>	s	r	h <sub>2</sub>	d <sub>4</sub>	f	Sayisi(Eac h)	Vida Screw	d <sub>2</sub>	
10	17.2	Değerler DIN 2637 (100kgf/cm <sup>2</sup> )'den alan maldır.													
40	48.3														
50	60.3	180	26	135	62	82	2.9	6	10	102	3	4	M20	22	4.55
65	76.1	205	26	160	68	98	3.2	6	12	122	3	8	M20	22	5.73
80	88.9	215	28	170	72	112	3.6	8	12	138	3	8	M20	22	6.69
100	114.3	250	30	200	78	138	4	8	12	162	3	8	M24	26	9.66
125	139.7	295	34	240	88	168	4.5	8	12	188	3	8	M27	30	15.1
150	168.3	345	36	280	95	202	5.6	10	12	218	3	8	M30	33	21.9
175	193.7	375	40	310	105	228	6.3	10	16	260	3	12	M30	33	23.7
200	219.1	415	42	345	110	256	7.1	10	16	285	3	12	M33	36	34.9
250	273	470	46	400	125	316	8.8	12	18	345	3	12	M33	36	49.6
300	323.9	530	52	460	140	372	11	12	18	410	4	16	M33	36	68.7
350	355.6	600	56	525	150	420	12.5	12	20	465	4	16	M36	39	94.6
400	406.4	670	60	585	160	475	14.2	12	20	535	4	16	M39	42	124

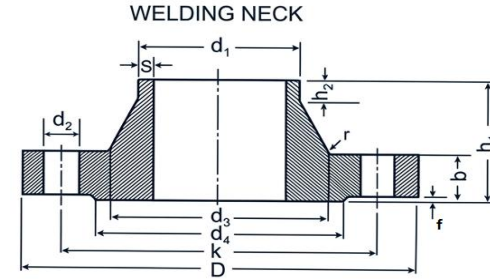
**Welding Neck Flange**
**Nominal Pressure: 100kgf/cm<sup>2</sup>-ND100**
**DIN2637**
**FLANSLAR**
**BORULARICIN,VIDALIBOYUNLARI KAYNAKLI**
**Anma Basinc1:100kgf/cm<sup>2</sup>-ND100**
**TS811/8 (TS ISO 7005-1)**

BORE(Pipe)		FLANS(Flange)				BOYUN(Neck)				ALIN ÇIKINTISI (Raised face)		CLVATALAE(Bolts)			FLANS AĞIRLIĞI (Flange Weight) (7.85kg/dm <sup>3</sup> )kg
DN	d <sub>1</sub> ISO/DIN	D	b	k	h <sub>1</sub>	d <sub>3</sub>	s	r	h <sub>2</sub>	d <sub>4</sub>	f	Sayisi(Each)	Vida Screw	d <sub>2</sub>	
10	17.2	100	20	70	45	32	1.8	4	6	40	2	4	M12	14	1.09
15	21.3	105	20	75	45	34	2	4	6	45	2	4	M12	14	1.19
25	33.7	140	24	100	58	52	2.6	4	8	68	2	4	M16	18	2.66
40	48.3	170	26	125	62	70	2.9	6	10	88	3	4	M20	22	4.09
50	60.3	195	28	145	68	90	3.2	6	10	102	3	4	M24	26	5.98
65	76.1	220	30	170	76	108	3.6	6	12	122	3	8	M24	26	7.91
80	88.9	230	32	180	78	120	4	8	12	138	3	8	M24	26	8.95
100	114.3	265	36	210	90	150	5	8	12	162	3	8	M27	30	13.7
125	139.7	315	40	250	105	180	6.3	8	12	188	3	8	M30	33	22.7
150	168.3	355	44	290	115	210	7.1	10	12	218	3	12	M30	33	30.2
175	193.7	385	48	320	127	245	8.8	10	16	260	3	12	M30	33	38.9
200	219.1	430	52	360	130	278	10	10	16	285	3	12	M33	36	52.8
250	273	505	60	430	157	340	12.5	12	18	345	3	12	M36	39	81.4
300	323.9	585	68	500	170	400	14.2	12	18	410	4	16	M39	42	122
350	355.6	655	74	560	189	460	16	12	20	465	4	16	M45	48	165

**LAPPED FLANGES WITH COLLAR**

 Nominal Pressure: 10kgf/cm<sup>2</sup>-ND10

DIN2642

**FLANGES**

BORULARICIN,DESTEKLIGEVSEK

 Anma Basinc1:10kgf/cm<sup>2</sup>-ND10

TS 814/2 (TS ISO 7005-1)

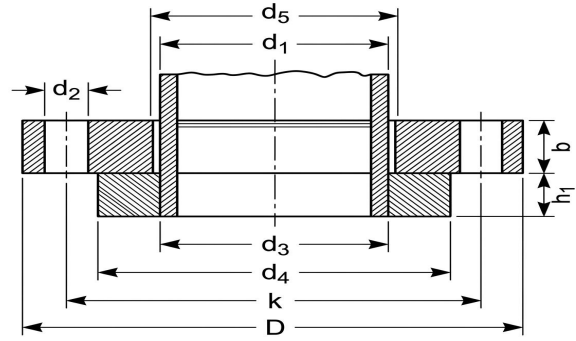

BORU(Pipe)			FLANS(Flange)			CIVATALAR(Bolts)		DESTEK(Beam)				AGIRLIK (Weight) 7.85kg/dm <sup>3</sup>	
DN	d <sub>1</sub>	D	d <sub>5</sub>	b	k	Sayisi (Each)	Vida (Screw)	d <sub>2</sub>	d <sub>3</sub>	d <sub>4</sub>	h <sub>1</sub>	Flans (flange) kg	Destek (Beam) kg
10	14	90	16	14	60	4	M12	14	17.7	40	10	0.599	0.087
	17.2		19										
15	20	95	22	14	65	4	M12	14	22	45	10	0.689	0.105
	21.3		24										
20	25	105	28	14	75	4	M12	14	27.6	58	12	0.806	0.203
	26.9		30										
25	30	115	33	16	85	4	M12	14	34.4	68	12	1.11	0.276
	33.7		36										
32	38	140	42	16	100	4	M16	18	43.1	78	12	1.64	0.343
	42.4		46										
40	44.5	150	50	16	110	4	M16	18	49	88	12	1.86	0.426
	48.3		54										
50	57	165	62	16	125	4	M16	18	61.1	102	14	2.2	0.618
	60.3		65										
65	76.1	185	81	16	145	4	M16	18	77.1	122	14	2.62	0.786
	88.9		94										
80	114.3	200	119	18	160	4/8	M16	18	90.3	138	16	3.32	1.1
	114.3		119										
100	108	220	113	18	180	8	M16	18	115.9	158	16	3.67	1.31
	114.3		119										
125	133	250	138	18	210	8	M16	18	141.6	188	18	4.54	1.96
	139.7		145										
150	168.3	285	173	18	240	8	M20	22	170.5	212	18	5.6	2.18
200	219.1	340	225	20	295	8	M20	22	221.8	268	20	7.46	3.1
250	273	395	279	22	350	12	M20	22	276.2	320	22	10.3	4.22
300	323.9	445	329	26	400	12	M20	22	327.6	370	22	14	4.85
350	355.6	505	362	28	460	16	M20	22	372.2	430	22	18.5	6.71
400	406.4	565	413	32	515	16	M24	26	423.7	482	24	25	8.28
-450	457	615	467	38	565	20	M24	26	462.5	532	24	30.6	9.3
500	508	670	517	38	620	20	M24	26	513.6	585	26	37	11.5
600	610	780	618	44	725	20	M27	30	616.3	685	26	56.3	15.6
700	711	895	721	50	840	24	M27	30	718.6	800	28	80.4	23.2
800	813	1015	824	56	950	24	M30	33	821.5	905	30	113.2	29.2

**LAPPED FLANGES WITH COLLAR**

 Nominal Pressure: 25kgf/cm<sup>2</sup>-ND25

DIN2655

**FLANGES**

BORULARICIN,DESTEKLIGEVSİK

 Anma Basincı:25kgf/cm<sup>2</sup>-ND25

TS 814/4 (TS ISO 7005-1)

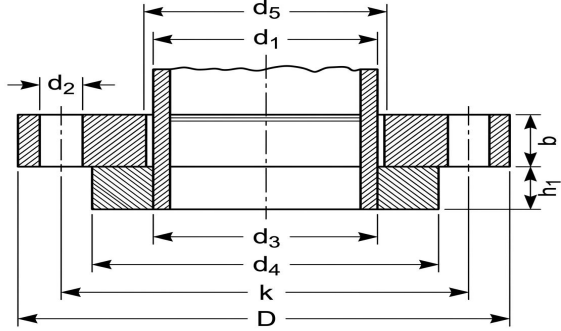

BORU(Pipe)			FLANS(Flange)			CIVATALAR(Bolts)		DESTEK(Beam)			AGIRLIK (Weight) 7.85kg/dm <sup>3</sup>		
DN	d <sub>1</sub>	D	d <sub>5</sub>	b	k	Sayisi (Each)	Vida (Screw)	d <sub>2</sub>	d <sub>3</sub>	d <sub>4</sub>	h <sub>1</sub>	Flans (flange) kg	Destek (Beam) kg
10	17.2	Değerler DIN 2656 (40 kgf/cm <sup>2</sup> ) den alınmalıdır											
150	168.3												
200	219.1	360	225	26	310	12	M24	26	221.8	278	24	11.7	4.53
250	273	425	279	30	370	12	M27	30	276.2	335	26	17.9	6.56
300	323.9	485	329	34	430	16	M27	30	327.6	395	28	24.7	8.8
350	355.6	555	362	38	490	16	M30	33	372.2	450	32	35.6	13.2
400	406.4	620	413	42	550	16	M33	36	423.7	505	34	47.5	16.5
500	508	730	517	50	660	20	M33	36	513.6	615	38	71.1	25.3

**LAPPED FLANGES WITH COLLAR**

 Nominal Pressure: 40kgf/cm<sup>2</sup>-ND40

DIN2656

**FLANGES**

BORULARICIN,DESTEKLIGEVSİK

 Anma Basincı:40kgf/cm<sup>2</sup>-ND40

TS 814/5 (TS ISO 7005-1)

BORU(Pipe)			FLANS(Flange)			CIVATALAR(Bolts)		DESTEK(Beam)			AGIRLIK (Weight) 7.85kg/dm <sup>3</sup>		
DN	d <sub>1</sub>	D	d <sub>5</sub>	b	k	Sayisi (Each)	Vida (Screw)	d <sub>2</sub>	d <sub>3</sub>	d <sub>4</sub>	h <sub>1</sub>	Flans (flange) kg	Destek (Beam) kg
10	17.2	90	19	16	60	4	M12	14	17.7	40	12	0.696	0.104
15	21.3	95	24	16	65	4	M12	14	22	45	12	0.773	0.126
20	26.9	105	30	16	75	4	M12	14	27.6	58	14	0.934	0.236
25	33.7	115	36	18	85	4	M12	14	34.4	68	14	1.26	0.321
32	42.4	140	46	18	100	4	M16	18	43.1	78	14	1.85	0.401
40	48.3	150	54	18	110	4	M16	18	49	83	14	2.1	0.498
50	60.3	165	65	20	125	4	M16	18	61.1	102	16	2.75	0.706
65	76.1	185	81	20	145	8	M16	18	77.1	122	16	3.11	0.898
80	88.9	200	94	22	160	8	M16	18	90.3	138	18	3.88	1.23
100	114.3	235	119	22	190	8	M20	22	115.9	162	20	5.23	1.8
125	139.7	270	145	24	220	8	M24	26	141.6	188	22	7.23	2.4
150	168.3	300	173	24	250	8	M24	26	170.5	218	22	8.6	3.02
200	219.1	375	225	30	320	12	M27	30	221.8	285	26	15.2	5.54
250	273	450	279	36	385	12	M30	33	276.2	345	30	25.7	8.83
300	323.9	515	329	40	450	16	M30	33	327.6	410	34	33.5	14
350	355.6	580	362	46	510	16	M33	36	372.2	465	38	50.2	18.9
400	406.4	660	413	50	585	16	M36	39	423.7	535	42	71.2	28.4