

BEVEL FOR WALL THICKNESS(*t*)
0.88" IN.(22.35mm) OR LESS.

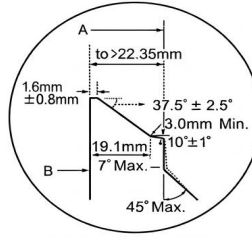

BEVEL FOR WALL THICKNESS(*t*)
GREATER THAN 0.88 IN.(22.35mm)

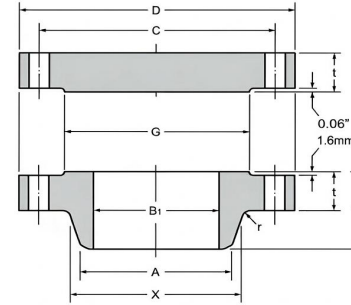

CLASS 75 FLANGES

ANSI B16.47 SER.B (API 605) FORGED FLANGES

Unit: mm

Nominal Pipe Size	Outside Diam.	O.D of Raised Face	Diam. of Hub at Base	Diam. of Hub at Beve	BORE			Length Thru Hub	THICKNESS		Radius at Base of Hub	DRILLING			Approximate Weight(kg)	
					Wall Thickness				Blind	Welding Neck		Bolt Circle Diam	Number of Holes	Diam. of Holes		
					6.35mm	9.5mm	12.7mm								t	t
26	762	704.9	676.1	661.9	647.7	641.4	635.0	58.7	33.3	33.3	7.9	723.9	36	19.1	36.3	115.7
28	813	755.7	726.9	712.7	698.5	692.2	685.8	62.0	33.3	33.3	7.9	774.7	40	19.1	38.6	131.5
30	864	806.5	777.7	763.5	749.3	743.0	736.6	65.0	33.3	33.3	7.9	825.5	44	19.1	40.8	149.7
32	914	857.3	828.5	814.3	800.1	793.8	787.4	69.9	36.6	35.1	7.9	876.3	48	19.1	47.6	176.9
34	965	908.1	879.3	865.1	850.9	844.6	838.2	73.2	38.1	35.1	7.9	927.1	52	19.1	49.9	195.0
36	1034	965.2	935.0	915.9	850.9	895.4	889.0	85.9	42.4	36.6	9.7	992.1	40	22.4	65.8	235.0
38	1084	1016.0	985.8	966.7	952.5	946.2	939.8	88.9	44.5	38.1	9.7	1042.9	40	22.4	72.6	269.9
40	1135	1066.8	1036.6	1017.5	1003.3	997.0	990.6	91.9	44.5	38.1	9.7	1093.7	44	22.4	77.1	344.7
42	1186	1117.6	1087.4	1068.3	1054.1	1047.8	1041.4	95.3	47.8	39.6	9.7	1144.5	48	22.4	83.9	406.0
44	1251	1174.8	1140.0	1119.1	1104.9	1098.6	1092.2	104.6	49.3	42.9	9.7	1203.5	36	25.4	104.3	483.1
46	1302	1225.6	1190.8	1169.9	1155.7	1149.4	1143.0	108.0	50.8	44.5	9.7	1254.3	40	25.4	111.1	537.5
48	1353	1276.4	1241.6	1220.7	1206.5	1200.2	1193.8	111.3	53.8	46.0	9.7	1305.1	44	25.4	122.5	596.5
50	1403	1327.2	1293.9	1271.5	1257.3	1251.0	1244.6	115.8	55.4	47.8	9.7	1355.9	44	25.4	131.5	682.7
52	1457	1378.0	1344.7	1322.3	1308.1	1301.8	1295.4	120.7	57.2	47.8	9.7	1409.7	48	25.4	140.6	755.2
54	1508	1428.8	1397.0	1373.1	1358.9	1352.6	1346.2	125.5	60.5	49.3	9.7	1460.5	48	25.4	154.2	834.6
56	1575	1485.9	1450.8	1423.9	1409.7	1403.4	1397.0	134.9	62.0	50.8	11.2	1521.0	40	28.4	181.4	957.1
58	1626	1536.7	1501.6	1474.7	1460.5	1454.2	1447.8	138.2	63.5	52.3	11.2	1571.8	44	28.4	195.0	1043.3
60	1676	1587.5	1552.4	1525.5	1511.3	1505.0	1498.6	144.5	66.5	55.6	11.2	1622.6	44	28.4	215.5	1134.0

Notes:

(1) Bore (B1) of flanges shall be specified by the purchaser.

(2) Class 300 flanges will be furnished with 0.06" (1.6mm) raised face which is included in Thickness (t) and Length thru Hub (T1).

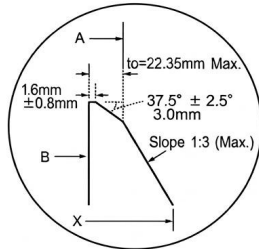

BEVEL FOR WALL THICKNESS(*t*_o)
0.88" IN.(22.35mm) OR LESS.

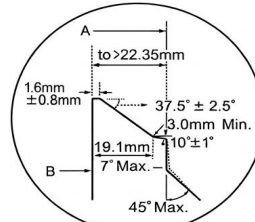

BEVEL FOR WALL THICKNESS(*t*_o)
GREATER THAN 0.88 IN.(22.35mm)

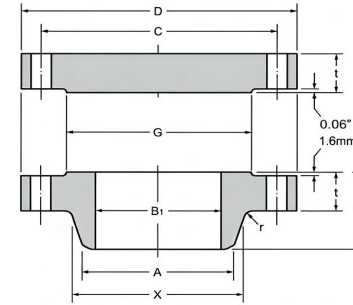

CLASS 75 FLANGES

ANSI B16.47 SER.B (API 605) FORGED FLANGES

Unit: mm

Nominal Pipe Size	Outside Diam.	O.D of Raised Face	Diam. of Hub at Base	Diam. of Hub at Beve	BORE			Length Thru Hub	THICKNESS		Radius at Base of Hub	DRILLING			Approximate Weight(kg)	
					Wall Thickness				Blind	Welding Neck		Bolt Circle Diam	Number of Holes	Diam. of Holes	Approximate Weight(kg)	
					6.35mm	9.5mm	12.7mm								Welding neck	Blind
D	G	X	A	B1			T1	t	t	r	c					
26	786	711.2	684.3	661.9	647.7	641.4	635.0	88.9	44.5	41.1	9.7	744.5	36	22.4	54.4	169.2
28	837	762.0	735.1	712.7	698.5	692.2	685.8	95.3	47.8	44.5	9.7	795.3	40	22.4	63.5	205.9
30	887	812.8	787.4	763.5	749.3	743.0	736.6	100.1	50.8	44.5	9.7	846.1	44	22.4	68.0	246.3
32	941	863.6	839.7	814.3	800.1	793.8	787.4	108.0	53.8	46.0	9.7	900.2	48	22.4	77.1	293.9
34	1005	920.8	892.0	865.1	850.9	844.6	838.2	110.2	57.2	49.3	9.7	957.3	40	25.4	95.3	355.2
36	1057	971.6	944.6	915.9	901.7	895.4	889.0	117.3	58.7	52.3	9.7	1009.7	44	25.4	108.9	403.7
38	1124	1022.4	997.0	968.2	952.5	946.2	939.8	124.0	63.5	53.8	9.7	1069.8	40	28.4	131.5	494.0
40	1175	1079.5	1049.3	1019.0	1003.3	997.0	990.6	128.5	66.5	55.6	9.7	1120.6	44	28.4	140.6	565.6
42	1226	1130.3	1101.9	1069.8	1054.1	1047.8	1041.4	133.4	68.3	58.7	11.2	1171.4	48	28.4	156.5	631.9
44	1276	1181.1	1152.7	1120.6	1104.9	1098.6	1092.2	136.7	71.4	60.5	11.2	1222.2	52	28.4	167.8	716.2
46	1341	1234.9	1205.0	1171.4	1155.7	1149.4	1143.0	144.5	74.7	62.0	11.2	1284.2	40	31.8	197.3	827.4
48	1392	1289.1	1257.3	1222.2	1206.5	1200.2	1193.8	149.4	77.7	65.0	11.2	1335.0	44	31.8	217.7	927.6
50	1443	1339.9	1308.1	1273.0	1257.3	1251.0	1244.6	153.9	80.8	68.3	11.2	1385.8	48	31.8	235.9	1036.0
52	1494	1390.7	1360.4	1323.8	1308.1	1301.8	1295.4	157.2	84.1	69.9	11.2	1436.6	52	31.8	249.5	1155.3
54	1549	1441.5	1412.7	1374.6	1358.9	1352.6	1346.2	162.1	87.4	71.4	11.2	1492.3	56	31.8	281.2	1291.9
56	1600	1492.3	1465.3	1425.4	1409.7	1403.4	1397.0	166.6	90.4	73.2	14.2	1543.1	60	31.8	294.8	1426.1
58	1675	1543.1	1516.1	1476.2	1460.5	1454.2	1447.8	174.8	93.5	74.7	14.2	1611.4	48	35.1	353.8	1614.8
60	1726	1600.2	1570.0	1527.0	1511.3	1505.0	1498.6	179.3	96.8	76.2	14.2	1662.2	52	35.1	385.6	1774.9

Notes:

(1) Bore (B1) of flanges shall be specified by the purchaser.

(2) Class 300 flanges will be furnished with 0.06" (1.6mm) raised face which is included in Thickness (t) and Length thru Hub (T1).

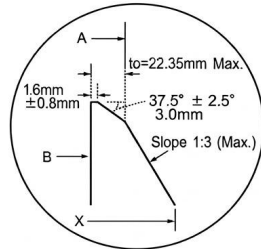

BEVEL FOR WALL THICKNESS(*t*)
0.88" IN.(22.35mm) OR LESS.

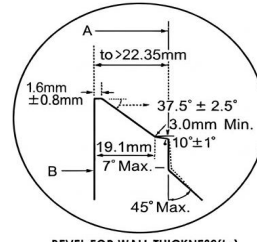

BEVEL FOR WALL THICKNESS(*t*)
GREATER THAN 0.88 IN.(22.35mm)

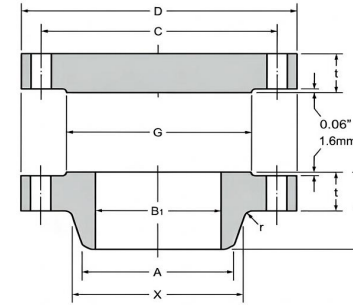

CLASS 75 FLANGES

ANSI B16.47 SER.B (API 605) FORGED FLANGES

Unit: mm

Nominal Pipe Size	Outside Diam.	O.D of Raised Face	Diam. of Hub at Base	Diam. of Hub at Beve	BORE			Length Thru Hub	THICKNESS		Radius at Base of Hub	DRILLING			Approximate Weight(kg)	
					Wall Thickness				Blind	Welding Neck		Bolt Circle Diam	Number of Holes	Diam. of Holes	Approximate Weight(kg)	
					6.35mm	9.5mm	12.7mm								Welding neck	Blind
D	G	X	A	B1			T1	t	t	r	c					
26	867	736.6	701.5	665.2	647.7	641.4	635.0	144.5	88.9	88.9	14.2	803.1	32	35.1	181.4	411.4
28	921	787.4	755.7	716.0	698.5	692.2	685.8	149.4	88.9	88.9	14.2	857.3	36	35.1	204.1	464.0
30	991	844.6	812.8	768.4	749.3	743.0	736.6	158.0	93.7	93.7	14.2	920.8	36	38.1	249.5	566.5
32	1054	901.7	863.6	819.2	800.1	793.8	787.4	168.1	103.1	103.1	15.7	977.9	32	41.1	310.7	705.8
34	1108	952.5	917.4	870.0	850.9	844.6	838.2	173.0	103.1	103.1	15.7	1031.7	36	41.1	340.2	779.7
36	1171	1009.7	965.2	920.8	901.7	895.4	889.0	180.8	103.1	103.1	15.7	1089.2	32	44.5	381.0	871.4
38	1222	1060.5	1016.0	971.6	952.5	946.2	939.8	192.0	111.3	111.3	15.7	1140.0	36	44.5	415.0	1023.8
40	1273	1114.6	1066.8	1022.4	1003.3	997.0	990.6	198.4	115.8	115.8	15.7	1190.8	40	44.5	449.1	1156.2
42	1334	1168.4	1117.6	1074.7	1054.1	1047.8	1041.4	204.7	119.1	119.1	15.7	1244.6	36	47.8	514.8	1304.6
44	1384	1219.2	1173.2	1125.5	1104.9	1098.6	1092.2	214.4	127.0	127.0	15.7	1295.4	40	47.8	560.2	1498.7
46	1461	1270.0	1228.9	1176.3	1155.7	1149.4	1143.0	222.3	130.0	128.5	15.7	1365.3	36	50.8	666.8	1708.3
48	1511	1327.2	1277.9	1227.1	1206.5	1200.2	1193.8	223.8	134.9	128.5	15.7	1416.1	40	50.8	714.4	1897.4
50	1562	1378.0	1330.5	1277.9	1257.3	1251.0	1244.6	235.0	139.7	138.2	15.7	1466.9	44	50.8	775.7	2099.7
52	1613	1428.8	1382.8	1328.7	1308.1	1301.8	1295.4	242.8	144.3	142.7	15.7	1517.7	48	50.8	834.6	2311.5
54	1673	1479.6	1435.1	1379.5	1358.9	1352.6	1346.2	239.8	149.4	136.7	15.7	1577.8	48	50.8	898.1	2575.5
56	1765	1536.7	1493.8	1430.3	1409.7	1403.4	1397.0	268.2	157.0	153.9	17.5	1651.0	36	60.5	1177.1	3012.8
58	1827	1593.9	1547.9	1481.1	1460.5	1454.2	1447.8	274.6	162.1	153.9	17.5	1712.0	40	60.5	1256.6	3332.6
60	1878	1651.0	1598.7	1531.9	1511.3	1505.0	1498.6	271.5	166.6	150.9	17.5	1763.8	40	60.5	1301.8	3619.7

Notes:

(1) Bore (B1) of flanges shall be specified by the purchaser.

(2) Class 300 flanges will be furnished with 0.06" (1.6mm) raised face which is included in Thickness (t) and Length thru Hub (T1).

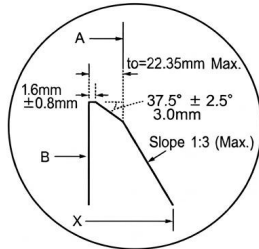

BEVEL FOR WALL THICKNESS(t_o)
0.88" IN.(22.35mm) OR LESS.

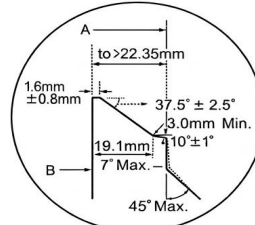

BEVEL FOR WALL THICKNESS(t_o)
GREATER THAN 0.88 IN.(22.35mm)

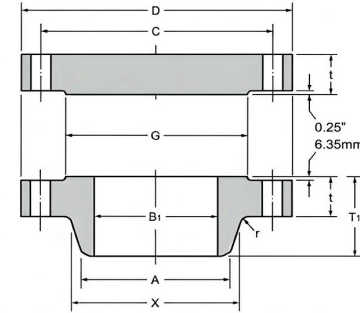

CLASS 75 FLANGES

ANSI B16.47 SER.B (API 605) FORGED FLANGES

Unit: mm

Nominal Pipe Size	Outside Diam.	O.D of Raised Face	Diam. of Hub at Base	Diam. of Hub at Beve	BORE			Length Thru Hub	THICKNESS		Radius at Base of Hub	DRILLING			Approximate Weight(kg)	
					Wall Thickness				Blind	Welding Neck		Bolt Circle Diam	Number of Holes	Diam. of Holes	Welding neck	Blind
					6.35mm	9.5mm	12.7mm									
D	G	X	A	B1			T1	t	t	r	c					
26	850.9	711.2	688.8	660.4	647.7	641.4	635.0	149.4	88.9	88.9	11.2	781.1	28	38.1	163.3	396.4
28	914.4	762.0	739.6	711.2	698.5	692.2	685.8	158.8	95.3	95.3	12.7	838.2	24	41.1	204.1	490.3
30	971.6	819.2	793.8	762.2	749.3	743.0	736.6	169.9	101.6	101.6	12.7	895.4	28	41.1	240.4	590.6
32	1035.1	873.3	844.6	812.8	800.1	793.8	787.4	179.3	108.0	108.0	12.7	952.5	28	44.5	288.0	712.2
34	1085.9	927.1	898.7	863.6	850.9	844.6	838.2	187.5	111.3	111.3	14.2	1003.3	32	44.5	313.0	807.9
36	1155.7	980.9	952.5	914.4	901.7	895.4	889.0	200.2	119.1	119.1	14.2	1066.8	28	47.8	387.8	979.8
38	1206.5	1035.1	1003.3	965.2	952.5	946.2	939.8	206.2	124.0	124.0	14.2	1117.6	32	47.8	424.1	1111.3
40	1270.0	1092.2	1054.1	1016.0	1003.3	997.0	990.6	215.9	130.0	130.0	14.2	1174.8	32	50.8	494.4	1291.9
42	1320.8	1143.0	1107.9	1066.8	1054.1	1047.8	1041.4	223.8	133.4	133.4	14.2	1225.6	32	50.8	539.8	1432.9
44	1384.3	1200.2	1158.7	1117.6	1104.9	1098.6	1092.2	233.2	139.7	139.7	14.2	1282.7	32	53.8	623.7	1648.8
46	1441.5	1257.3	1212.9	1168.4	1155.7	1149.4	1143.0	244.3	146.1	146.1	14.2	1339.9	36	53.8	691.7	1868.8
48	1511.3	1308.1	1267.0	1219.2	1206.5	1200.2	1193.8	257.0	152.4	152.4	14.2	1403.4	28	60.5	811.9	2143.7
50	1568.5	1361.9	1320.8	1270.0	1257.3	1251.0	1244.6	268.2	158.8	157.2	14.2	1460.5	32	60.5	884.5	2405.4
52	1619.3	1412.7	1371.6	1320.8	1308.1	1301.8	1295.4	276.4	163.6	162.1	14.2	1511.3	32	60.5	963.9	2641.3
54	1701.8	1470.2	1425.4	1371.6	1358.9	1352.6	1346.2	289.1	171.5	169.9	14.2	1581.2	28	66.5	1163.5	3058.2
56	1752.6	1527.0	1479.6	1424.2	1409.7	1403.4	1397.0	298.5	176.3	174.8	14.2	1632.0	32	66.5	1229.3	3334.9
58	1803.4	1577.8	1530.4	1473.2	1460.5	1454.2	1447.8	306.3	180.8	177.8	14.2	1682.8	32	66.5	1465.1	3622.4
60	1886.0	1635.3	1584.5	1524.0	1511.3	1505.0	1498.6	319.0	189.0	185.7	14.2	1752.6	32	73.2	1732.8	4139.6

Notes:

(1)Dimensions for class 600,900 NPS 36"and larger as the same as for series A flanges.

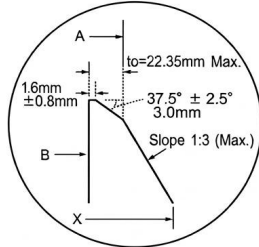

BEVEL FOR WALL THICKNESS(t_o)
0.88" IN.(22.35mm) OR LESS.

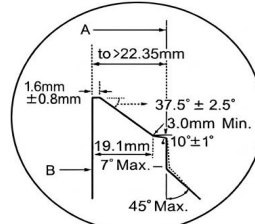

BEVEL FOR WALL THICKNESS(t_o)
GREATER THAN 0.88 IN.(22.35mm)

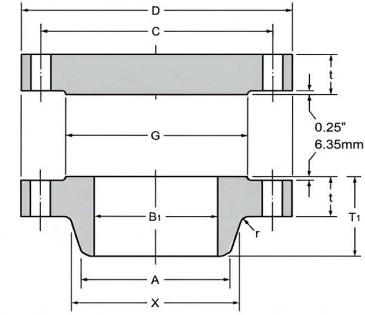

CLASS 75 FLANGES

ANSI B16.47 SER.B (API 605) FORGED FLANGES

Unit: mm

Nominal Pipe Size	Outside Diam.	O.D of Raised Face	Diam. of Hub at Base	Diam. of Hub at Beve	BORE			Length Thru Hub	THICKNESS		Radius at Base of Hub	DRILLING			Approximate Weight(kg)	
					Wall Thickness				Blind	Welding Neck		Bolt Circle Diam	Number of Holes	Diam. of Holes	Approximate Weight(kg)	
					6.35mm	9.5mm	12.7mm								Welding neck	Blind
D	G	X	A	B1			T1	t	t	r	c					
26	889.0	726.9	698.5	660.4	647.7	641.4	635.0	180.8	111.3	111.3	12.7	806.5	28	44.5	249.5	541.6
28	952.5	784.4	752.3	711.2	698.5	692.2	685.8	190.5	115.8	115.8	12.7	863.6	28	47.8	294.8	647.3
30	1022.4	841.2	806.5	762.0	749.3	743.0	736.6	204.7	127.0	125.5	12.7	927.1	28	50.8	367.4	817.4
32	1085.9	895.4	860.6	812.8	800.1	793.8	787.4	215.9	134.9	130.0	12.7	984.3	28	53.8	430.9	979.3
34	1162.1	952.5	914.4	863.6	850.9	844.6	838.2	233.4	144.3	141.2	14.2	1054.1	24	60.5	546.6	1199.8
36	1212.9	1009.7	968.2	914.4	901.7	895.4	889.0	242.8	150.9	146.1	14.2	1104.9	28	60.5	607.8	1366.7
38	1270.0	1054.1	1022.4	965.2	952.5	946.2	939.8	254.0	155.4	152.4	14.2	1162.3	28	60.5	666.8	1544.1
40	1320.8	1111.3	1073.2	1016.0	1003.3	997.0	990.6	263.7	162.1	158.8	14.2	1212.9	32	60.5	739.4	1740.9
42	1403.4	1168.4	1127.3	1066.8	1054.1	1047.8	1041.4	279.4	171.5	168.1	14.2	1282.7	28	66.5	920.8	2079.8
44	1454.2	1225.6	1181.1	1117.6	1104.9	1098.6	1092.2	289.1	177.8	173.0	14.2	1333.5	32	66.5	979.8	2315.6
46	1511.3	1276.4	1234.9	1168.4	1155.7	1149.4	1143.0	300.0	185.7	179.3	14.2	1390.7	32	66.5	1093.2	2611.8
48	1593.9	1333.5	1289.1	1219.2	1206.5	1200.2	1193.8	316.0	195.3	189.0	14.2	1460.5	32	73.2	1295.0	3055.9
50	1670.1	1384.3	1343.2	1270.0	1257.3	1251.0	1244.6	328.7	203.2	196.9	14.2	1524.0	28	79.2	1510.5	3490.5
52	1720.9	1435.1	1394.0	1320.8	1308.1	1301.8	1295.4	336.6	209.6	203.2	14.2	1574.8	32	79.2	1614.8	3822.0
54	1778.0	1492.3	1447.8	1371.6	1358.9	1352.6	1346.2	349.3	217.4	209.6	14.2	1632.0	32	79.2	1778.1	4233.4
56	1854.2	1543.1	1501.6	1422.4	1409.7	1403.4	1397.0	362.0	225.6	217.4	15.8	1695.5	32	85.9	1941.4	4776.0
58	1905.0	1600.2	1552.4	1473.2	1460.5	1454.2	1447.8	369.8	231.6	222.3	15.8	1746.3	32	85.9	2104.7	5177.4
60	1993.9	1657.4	1609.9	1524.0	1511.3	1505.0	1498.6	388.9	242.8	233.4	17.5	1822.5	28	91.9	2268.0	5945.8

Notes:

(1)Dimensions for class 600,900 NPS 36"and larger as the same as for series A flanges.

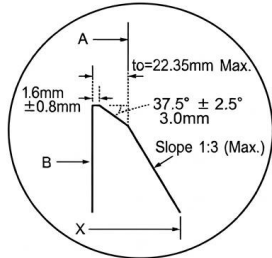

BEVEL FOR WALL THICKNESS(to)
0.88" IN.(22.35mm) OR LESS.

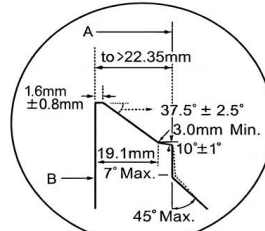

BEVEL FOR WALL THICKNESS(to)
GREATER THAN 0.88 IN.(22.35mm)

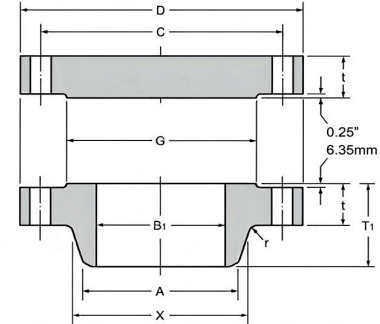

CLASS 75 FLANGES

ANSI B16.47 SER.B (API 605) FORGED FLANGES

Unit: mm

Nominal Pipe Size	Outside Diam.	O.D of Raised Face	Diam. of Hub at Base	Diam. of Hub at Beve	BORE			Length Thru Hub	THICKNESS		Radius at Base of Hub	DRILLING			Approximate Weight(kg)	
					Wall Thickness				Blind	Welding Neck		Bolt Circle Diam	Number of Holes	Diam. of Holes	Welding neck	Blind
					6.35mm	9.5mm	12.7mm									
D	G	X	A	B1			T1	t	t	r	c					
26	1022.4	762.0	743.0	660.4	647.7	641.4	635.0	258.8	153.9	134.9	11.2	901.7	20	66.5	476.3	990.7
28	1104.9	819.2	797.1	711.2	698.5	692.2	685.8	276.4	166.6	147.6	12.7	971.6	20	73.2	689.5	1252.8
30	1181.1	876.3	850.9	762.0	749.3	743.0	736.6	289.1	176.0	155.4	12.7	1035.1	20	79.2	825.6	1512.3
32	1238.3	927.1	908.1	812.8	800.1	793.8	787.4	303.3	185.7	160.3	12.7	1092.2	20	79.2	936.7	1753.2
34	1314.5	990.6	962.2	863.6	850.9	844.6	838.2	319.0	195.1	171.5	14.2	1155.7	20	85.9	1111.3	2075.7
36	1346.2	1028.7	1016.0	914.4	901.7	895.4	889.0	325.4	201.7	173.0	14.2	1200.2	24	79.2	1143.1	2251.2
38	1460.5	1098.6	1073.2	965.2	952.5	946.2	939.8	352.6	215.9	190.5	19.1	1289.1	20	91.9	1535.4	2836.4
40	1511.3	1162.1	1127.3	1016.0	1003.3	997.0	990.6	363.5	223.8	196.9	20.6	1339.9	24	91.9	1642.0	3148.0
42	1562.1	1212.9	1176.3	1066.8	1054.1	1047.8	1041.4	371.3	231.6	206.2	20.6	1390.7	24	91.9	1796.3	3481.4
44	1648.0	1270.0	1234.9	1117.6	1104.9	1098.6	1092.2	390.7	242.8	214.4	22.4	1463.5	24	98.6	1950.5	4061.5
46	1733.6	1333.5	1292.4	1168.4	1155.7	1149.4	1143.0	411.0	255.5	225.6	22.4	1536.7	24	104.6	2104.7	4729.2
48	1784.4	1384.3	1343.2	1219.2	1206.5	1200.2	1193.8	419.1	263.7	233.4	23.9	1587.5	24	104.6	2258.9	5170.1

Notes:

(1)Dimensions for class 600,900 NPS 36"and larger as the same as for series A flanges.